





d ₁	DIN984 D2000 JK											Groove				D A T A							
		s	Tolerance	d ₃	Tolerance	a max.	b =	d _{5 min.}	C ₁	C ₂	Weight (kg/1000)	d ₂	Tolerance	m min.	t	n	FN (kN)	FR (kN)	g	FRg (kN)	AN (mm ²)	B	
16	JK16	1.00		17.3		3.4	2.1	1.7	9.0	10.0	0.72	16.8	+0.11	1.10	0.40	1.2	3.40	5.5	1.0	2.5	20.6	18.4	4
17	JK17	1.00		18.3		3.7	2.2	1.7	9.4	10.4	0.80	17.8		1.10	0.40	1.2	3.60	6.0	1.0	2.5	21.8	18.1	4
18	JK18	1.00		19.5		4.1	2.3	2.0	9.6	10.8	0.90	19.0		1.10	0.50	1.5	4.80	6.5	1.0	2.6	29.0	18.2	4
19	JK19	1.00		20.5		3.8	2.3	2.0	11.2	12.4	0.99	20.0		1.10	0.50	1.5	5.10	6.8	1.0	2.6	30.6	17.2	4
20	JK20	1.00		21.5	+0.42 -0.13	3.9	2.4	2.0	12.0	13.2	1.06	21.0		1.10	0.50	1.5	5.40	7.2	1.0	2.6	32.2	16.9	4
21	JK21	1.00		22.5		4.0	2.4	2.0	12.8	14.0	1.17	22.0	+0.15	1.10	0.50	1.5	5.70	7.6	1.0	2.6	33.8	17.2	4
22	JK22	1.00		23.5		4.0	2.6	2.0	13.8	15.0	1.28	23.0		1.10	0.50	1.5	5.90	8.0	1.0	2.7	35.3	17.6	4
23	JK23	1.20		24.6		4.1	2.6	2.0	14.6	15.9	1.48	24.1		1.30	0.55	1.6	6.80	13.8	1.0	4.5	40.7	28.8	4
24	JK24	1.20		25.9		4.2	2.6	2.0	15.4	16.8	1.60	25.2		1.30	0.60	1.8	7.70	13.9	1.0	4.6	46.3	28.4	4
25	JK25	1.20		26.9	+0.42 -0.21	4.4	2.8	2.0	16.0	17.4	1.72	26.2		1.30	0.60	1.8	8.00	14.6	1.0	4.7	48.2	29.0	4
26	JK26	1.20		28.5		4.4	2.8	2.0	17.0	18.4	2.00	27.2	+0.21	1.30	0.60	1.8	8.40	13.8	1.0	4.6	50.1	27.8	4
27	JK27	1.20		29.1		4.5	2.9	2.0	17.8	19.4	2.00	28.4		1.30	0.70	2.1	10.10	13.3	1.0	4.5	60.9	26.6	4
28	JK28	1.20		30.1		4.9	3.0	2.0	18.0	19.6	2.10	29.4		1.30	0.70	2.1	10.50	13.3	1.0	4.5	63.1	26.3	4
30	JK30	1.20		32.1		4.9	3.2	2.0	20.0	21.6	2.35	31.4		1.30	0.70	2.1	11.30	13.7	1.0	4.6	67.5	26.6	4
31	JK31	1.20	-0.06	33.4		5.0	3.2	2.5	20.8	22.7	2.42	32.7		1.30	0.85	2.5	14.10	13.8	1.0	4.7	84.8	26.8	4
32	JK32	1.20		34.4		5.1	3.3	2.5	21.5	23.5	2.50	33.7		1.30	0.85	2.5	14.60	13.8	1.0	4.7	87.9	26.6	4
33	JK33	1.20		35.5	+0.50 -0.25	5.1	3.3	2.5	22.5	24.5	2.65	34.7		1.30	0.85	2.5	15.00	14.3	1.5	4.9	90.3	27.0	4
34	JK34	1.50		36.5		5.3	3.4	2.5	23.1	25.1	3.80	35.7		1.60	0.85	2.5	15.40	26.2	1.5	6.3	92.6	50.0	4
35	JK35	1.50		37.8		5.5	3.6	2.5	23.7	26.0	4.00	37.0		1.60	1.00	3.0	18.80	26.9	1.5	6.4	113.0	50.5	4
36	JK36	1.50		38.8		5.6	3.6	2.5	24.5	26.8	4.15	38.0	+0.25	1.60	1.00	3.0	19.40	26.4	1.5	6.4	116.0	50.2	4
38	JK38	1.50		40.8		6.1	3.8	2.5	25.5	27.8	4.40	40.0		1.60	1.00	3.0	22.50	28.2	1.5	6.7	123.0	51.7	4
40	JK40	1.75		43.5		7.2	4.0	2.5	25.2	28.1	5.30	42.5		1.85	1.25	3.8	27.00	44.6	2.0	8.3	162.0	80.1	4
42	JK42	1.75		45.5		7.2	4.1	2.5	27.2	30.1	6.00	44.5		1.85	1.25	3.8	28.40	44.7	2.0	8.4	170.0	80.9	4
44	JK44	1.75		47.5	+0.90 -0.39	7.2	4.2	2.5	29.3	32.1	6.45	46.5		1.85	1.25	3.8	29.50	43.3	2.0	8.3	177.0	78.6	4
45	JK45	1.75		48.5		7.2	4.3	2.5	30.3	33.1	6.60	47.5		1.85	1.25	3.8	30.20	43.1	2.0	8.2	181.0	78.1	4
47	JK47	1.75		50.5		7.2	4.5	2.5	32.3	35.1	6.90	49.5		1.85	1.25	3.8	31.40	43.5	2.0	8.3	189.0	78.9	4
48	JK48	1.75		51.5		7.2	4.5	2.5	33.3	36.1	7.50	50.5		1.85	1.25	3.8	32.00	43.2	2.0	8.4	193.0	78.5	4
50	JK50	2.00		54.2		8.2	4.7	2.5	33.3	36.6	8.50	53.0		2.15	1.50	4.5	40.50	60.8	2.0	12.1	243.0	111.0	4
52	JK52	2.00		56.2		8.2	4.7	2.5	35.2	38.6	9.40	55.0		2.15	1.50	4.5	42.00	60.2	2.0	12.0	252.0	108.0	4
55	JK55	2.00		59.2	+1.10 -0.46	8.2	5.1	2.5	38.2	41.6	9.75	58.0		2.15	1.50	4.5	44.40	60.3	2.0	12.5	266.0	111.0	4
57	JK57	2.00	-0.07	61.2		8.2	5.2	2.5	40.2	43.6	11.65	60.0	+0.30	2.15	1.50	4.5	46.00	60.8	2.0	12.7	276.0	112.0	4
58	JK58	2.00		62.2		8.2	5.3	2.5	41.2	44.6	12.00	61.0		2.15	1.50	4.5	46.70	60.8	2.0	12.7	280.0	112.0	4
60	JK60	2.00		64.2		8.2	5.5	2.5	43.2	46.6	12.70	63.0		2.15	1.50	4.5	48.30	61.0	2.0	13.0	290.0	113.0	4
62	JK62	2.00		66.2		8.2	5.6	2.5	45.2	48.6	12.75	65.0		2.15	1.50	4.5	49.80	60.9	2.0	13.0	299.0	112.0	4
65	JK65	2.50		69.2		10.2	5.8	3.0	44.1	47.6	16.70	68.0		2.65	1.50	4.5	51.80	121.0	2.5	20.8	313.0	220.0	4



d ₁	DIN984 D2000 JK											D A T A											
		s	Tolerance	d ₃	Tolerance	a max.	b =	d _{5 min.}	C ₁	C ₂	Weight (kg/1000)	d ₂	Tolerance	m min.	t	n	FN (kN)	FR (kN)	g	FRg (kN)	AN (mm ²)	B	
67	JK67	2.50	-0.07	71.5	+1.10 -0.46	10.2	6.0	3.0	46.1	49.6	18.60	70.0	+0.30	2.65	1.50	4.5	53.80	121.0	2.5	21.1	323.0	222.0	4
68	JK68	2.50		72.5		10.2	6.1	3.0	47.1	50.6	19.30	71.0		2.65	1.50	4.5	54.50	121.0	2.5	21.2	327.0	222.0	4
70	JK70	2.50		74.5		10.2	6.2	3.0	49.1	52.6	20.20	73.0		2.65	1.50	4.5	56.20	119.0	2.5	21.0	337.0	218.0	4
72	JK72	2.50		76.5		10.2	6.4	3.0	51.1	54.6	21.20	75.0		2.65	1.50	4.5	58.00	119.0	2.5	21.0	346.0	217.0	4
75	JK75	2.50		79.5		10.2	6.6	3.0	54.1	57.6	22.60	78.0		2.65	1.50	4.5	60.00	118.0	2.5	21.0	360.0	215.0	4
80	JK80	2.50	-0.08	85.5	+1.30 -0.54	10.2	7.0	3.0	59.1	63.1	25.00	83.5	+0.35	2.65	1.75	5.3	74.60	120.0	2.5	21.8	448.0	219.0	4
85	JK85	3.00		90.5		12.2	7.4	3.5	60.1	64.1	30.10	88.5		3.15	1.75	5.3	79.50	201.0	3.0	31.2	477.0	364.0	4
90	JK90	3.00		95.5		12.2	7.7	3.5	65.1	69.1	35.50	93.5		3.15	1.75	5.3	84.00	199.0	3.0	31.4	504.0	364.0	4
95	JK95	3.00		100.5		12.2	8.1	3.5	70.1	74.1	40.00	98.5		3.15	1.75	5.3	88.60	195.0	3.0	31.4	532.0	365.0	4
100	JK100	3.00		105.5		12.2	8.5	3.5	75.1	79.1	43.50	103.5		3.15	1.75	5.3	93.10	188.0	3.0	30.8	559.0	359.0	4
110	JK110	4.00	-0.10	117.0	+1.50 -0.63	12.2	9.0	3.5	85.1	89.6	73.00	114.0	+0.54	4.15	2.00	6.0	117.00	415.0	3.0	71.0	704.0	824.0	4
115	JK115	4.00		122.0		12.2	9.3	3.5	89.5	94.6	82.00	119.0		4.15	2.00	6.0	122.00	409.0	3.0	71.2	735.0	829.0	4
120	JK120	4.00		127.0		12.2	9.6	3.5	94.4	99.6	87.00	124.0		4.15	2.00	6.0	127.00	396.0	3.0	70.0	767.0	818.0	4
125	JK125	4.00		132.0		12.2	9.9	4.0	99.4	104.6	92.00	129.0		4.15	2.00	6.0	132.00	385.0	3.0	70.0	797.0	809.0	4
130	JK130	4.00		137.0		12.2	10.2	4.0	104.3	109.6	102.00	134.0		4.15	2.00	6.0	138.00	374.0	3.0	69.0	829.0	801.0	4
140	JK140	4.00	-0.10	148.0	+1.50 -0.63	14.2	10.7	4.0	110.2	115.6	112.00	144.0	+0.63	4.15	2.00	6.0	148.00	350.0	3.0	66.5	892.0	775.0	4
150	JK150	4.00		158.0		14.2	11.1	4.0	120.1	126.6	123.00	155.0		4.15	2.50	7.5	191.00	326.0	3.0	64.0	1198.0	748.0	4
160	JK160	4.00		169.0		14.2	11.8	4.5	130.0	136.6	133.00	165.0		4.15	2.50	7.5	212.00	321.0	3.5	54.5	1275.0	737.0	4
170	JK170	4.00		179.5		14.2	12.3	4.5	139.9	146.6	145.00	175.0		4.15	2.50	7.5	225.00	349.0	3.5	59.0	1355.0	800.0	4

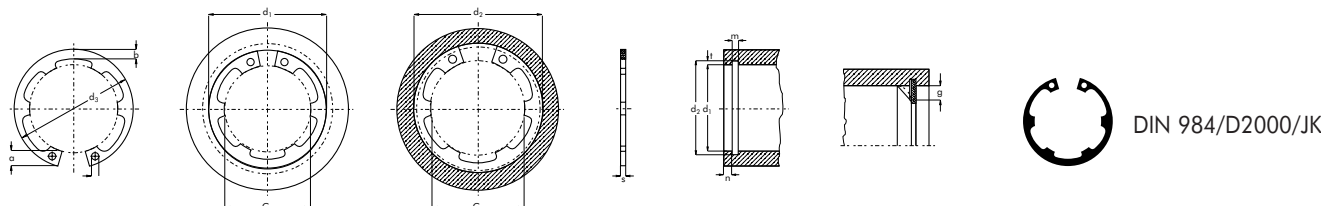

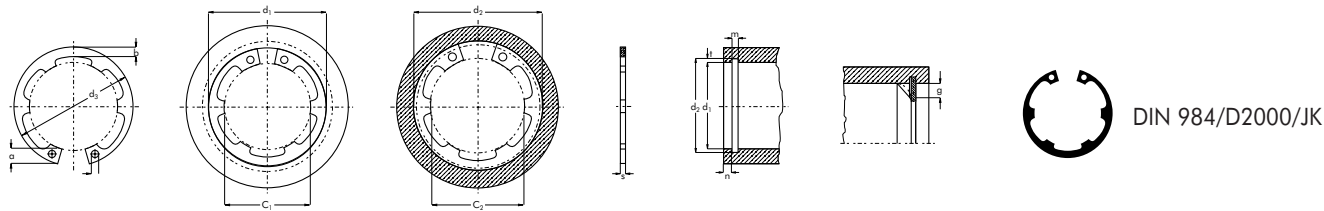
Add:L-2,FL21,INTL CONVENTION & EXHIBITION CENTER BUILDING,NB P.R.CHINA Tel:+86-574-87714998, +86-574-87714118
 Fax:+86-574-87714808 E-mail:sales@nb-speedtrading.com Http://www.nb-speedtrading.com MSN:shelllee_fu@hotmail.com